

# TAKSIM



A 21<sup>st</sup> CENTURY PLACE FOR ALL

# THE NEW TAKSİM MASTERPLAN

## TAKSİM : A 21st CENTURY PLACE FOR ALL

Taksim Square and Gezi Park are two of the most significant public places in Istanbul, if not all of Turkey. Located at an important crossroads for the city it is also the locus of important historical events, from its original role in bringing water to the city, to a cherished green park, and a place for the expression of ideas, protests and important social movements. Taksim Square and Gezi Park have been physically altered over the years yet both retain symbolic importance and iconic significance to the city and to all of Turkey. Like many important public places in other great cities of the world, its future is a focus of great interest.

Taksim today is physically fragmented, split between the vast unrelieved paved spaces, an ambiguous or unclear relationship to the surrounding context and green spaces with unrealized potential. Taksim Square and Gezi Park deserve a careful rethinking to realize its full potential, and meet the needs of Istanbul and Turkey in the 21st century, from places for safe assembly, locations and activities that meet the needs of all ages and beliefs, and a performative focus that can help to address the challenge of climate change and beyond.

We have three main goals for this design:

- Unite Taksim and Gezi Park in a vision that is welcoming to all;
- Enhance the experience with more park space that offers something for all;
- Engage the community with a place that is flexible for diverse activities and connected to the surrounding context, becoming an icon for Istanbul in the 21st century.

Our approach is outlined in the following text.

Taksim Square becomes a place for everyone and everything  
As one of the most important places in the historical and recent past of the country, the New Taksim Square embraces its role as a locus for individual and group expression and offers a place where all parts of modern Turkish society feel welcome and a sense of pride and ownership. Our design achieves this in the following manner:

- The New Taksim Square and expanded Gezi Park is proposed with a greatly enlarged green park paired with a well-defined urban plaza, offering a variety of public places and venues that appeal to society's youngest members (playgrounds, splash parks, informal sports areas, etc...) as well as increased areas for informal seating so important to senior citizens;
- The strategy integrates with the Culture Valley via pathways and connections to the north and towards the waterfront;
- The design is people-oriented and flexible to both engage day-to-day activities or host major events and gatherings in the redefined urban plaza. The park extension is designed to overlook the plaza, offering additional places for participation in public events and engagement within the square itself.
- The proposal greatly expands both the amount of usable green park space in the city, from 43,565 square meters of usable green space to 55,770 square meters in the proposed design, so necessary for city living particularly in the time of Covid-19.
- New access to the expanded park is made via ramps and elevators leading from Taksim Square and the adjacent neighborhoods into the park;
- The existing Gezi Park is enhanced via new uses, improves access and greater environmental performance.

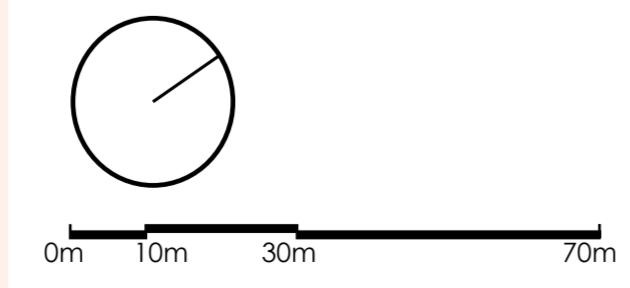

TAKSİM KONKUR COLLABORATIVE ORGANIZATION CHART



Team members shown in *italic* will join the team at Stage 2

# GREAT PLACES: THE PARK

## Enhance adjacent neighborhoods with the New Taksim Square and Park via commercial and cultural activities

Our vision extends beyond the competition boundaries and engages adjacent neighborhoods and cultural resources, from the nearby Beyoglu and other Pera neighborhoods to the Ataturk Cultural Center and the new mosque. Each adjacent neighborhood is unique and the design recognizes differences in use and scale and adapts accordingly with the following elements and strategies:

- A new pedestrian bridge over the Asker Ocagi Cad. provides a reimagined pedestrian walkway that connects the hotel district, the university campus, Macka Demokrasi Park and open air theater to Taksim;
- The new mosque and the Ataturk Cultural Center are each framed by a viewing pavilion where the Square and the Park meet and spatially connected via a green terraced ramp/stair that also extends the new park edge to the Tak-i Zafer Cad.
- A new Taksim Arts District hosting arts and crafts venues and based upon the Ramblas in Barcelona provides places for outdoor dining, and art installations located along Cumhuriyet Cad. with shaded outdoor places, new studios and galleries located in the base of the park terrace, engaging with the existing Metro entry, retail and hospitality activities in the adjacent neighborhood;

## The New Taksim Square and Gezi Park: United yet varied, vibrant and distinct

We embrace the historical and current-day importance of Taksim while recognizing that the vast area of the district offers the potential to introduce and enhance cultural focal points, public buildings, educational institutions and tourism activities in both the Taksim Square and Park. These activities and venues will continue to enrich the life of the city via a new, more focused set of formal relationships that add green space, articulate urban places that complement green areas, support ongoing activities, introduce new ones and provide places that can be enjoyed on a daily basis as well as for special events.

Within the new Taksim Square and Park, we propose the following:

- Gathering places for formal and informal activities woven throughout the texture of the park, from a small, informal amphitheater and splash park across from the Ataturk Cultural Center that can engage new video resources at the Cultural Center to an outdoor concert venue in the park's center that also provides convenient access to the relocated intermodal station under the park;
- A new two-level market and gallery building as the focal point for the urban plaza and providing a flexible locus for commercial activities and can double as a stage for events such as concerts and other activities and host exhibitions on the upper level;
- Locations for public art (plan and views contain placeholders for art proposals) identified throughout the plan, from areas adjacent to the Ataturk Culture Center to locations throughout the park, breathing fresh life via public art in and around Taksim Square and featuring the best Turkish artists of today as well as reserving places for those yet to come;
- Enhancements of the area adjacent to the wall of the Cumhuriyet Sanat Galerisi facing Taksim Square, with new lighting and adaptable tent awnings that can mitigate climate issues and enhance the traditional flower stalls and markets in the area;
- Security through the Square and the Park enhanced via the introduction of new solar powered light fixtures and supported by retail programming, both permanent and flexible or temporary, that provides secure "eyes on the street".
- More specifically, retail establishments in the base of the park terrace, facing the Monument of the Republic provide 24 hour activity adjacent to a stair that both provides entry to the park, an entry to the Metro and the

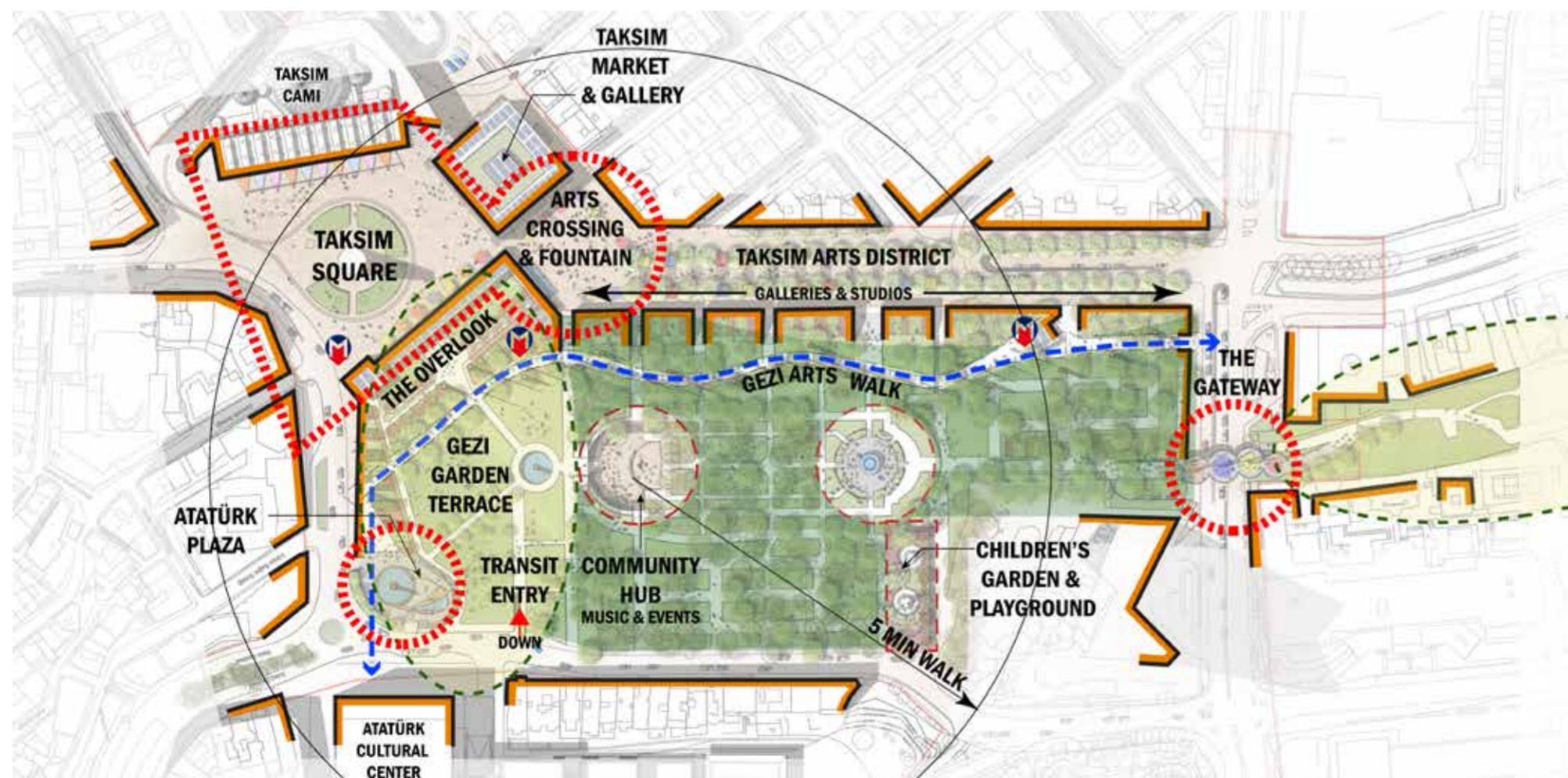

PLACES DIAGRAM

# GREAT PLACES: THE PARK

Turkey Oak  
*Quercus Cerris*



Stone Pine  
*Pinus Pinea*



Judas Tree  
*Cercis Siliquastrum*



Magnolia  
*Magnolia virginiana*



Mediterranean Cypress  
*Cercis Siliquastrum*



# GREAT PLACES - TAKSIM HISTORY

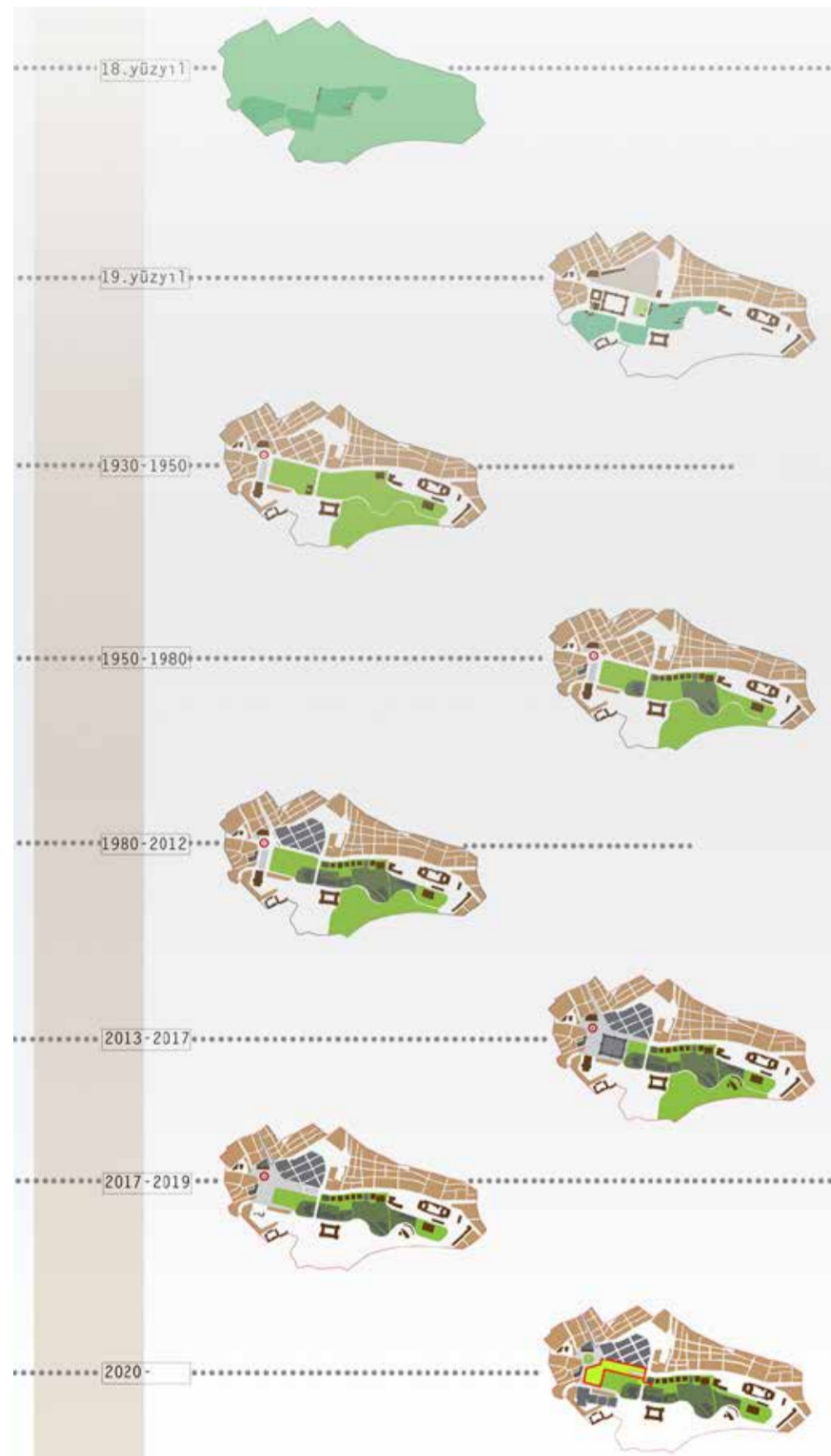

TAKSIM'S EVOLUTION

TAKSIM in the 1930s



TAKSIM in the 1930s



TAKSIM in the 1950s



TAKSIM in 2013



# GREAT PLACES: THE PLAZA

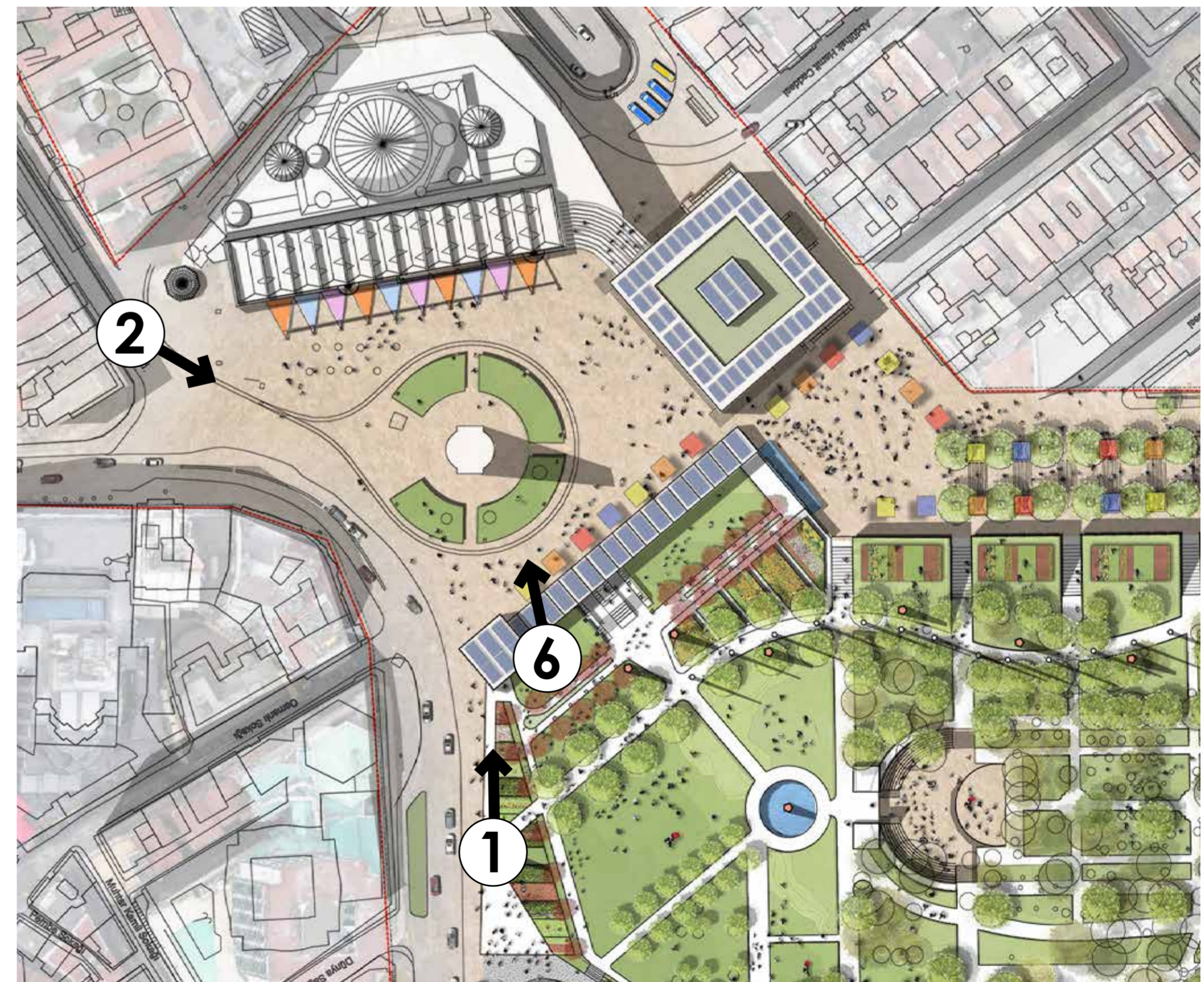



CONTINUE ISTANBUL'S GREAT TRADITION OF PUBLIC ART

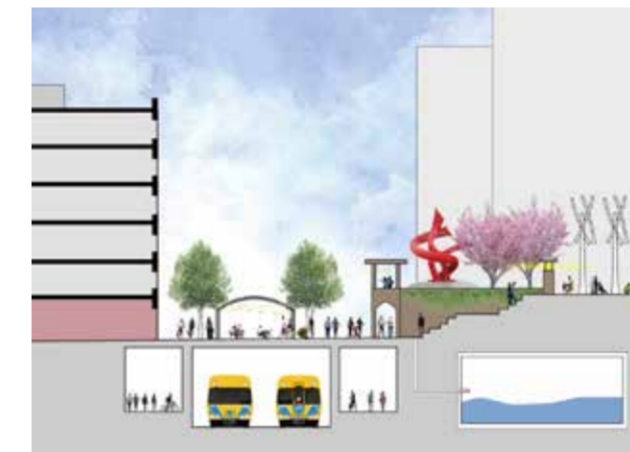
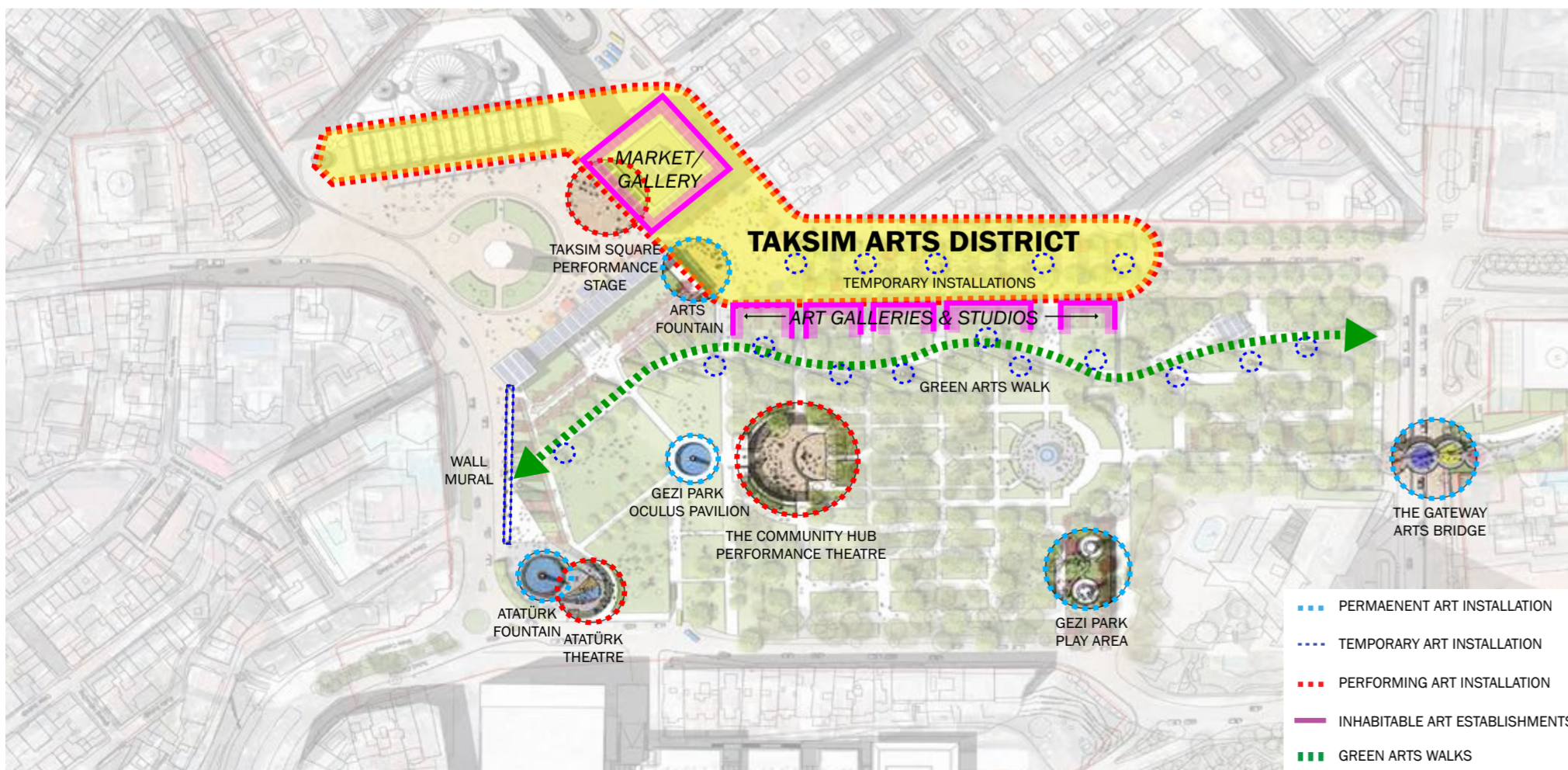

# TAKSIM: THE TRANSPORTATION HUB

## Enhancing the Taksim experience with Transit

The Taksim area today is well-served by a metro system that connects to the region as well as to important nearby locations like the waterfront at the Bosphorus. Yet, although transit access is convenient throughout the district, several challenges remain. For example, entries to the mass transit resources are utilitarian in design, regional and local buses invade the Square causing many pedestrian conflicts particularly on the northeast quadrant, and an overall sense of arrival is severely lacking. The New Taskim Square and Gezi Park weaves a new and more positive transit approach into the overall design of the place, making it inseparable from the overall experience. This is achieved in the following manner:

- Station entries to the Metro are designed with significant architectural features that embrace the uniqueness of each location;
- A new local and regional intermodal transit station is located below the new extended park terrace, illuminated by courtyards of the park, providing convenient access to the entries to the Metro and organizing the haphazard bus staging areas at the perimeter of the Square.
- New wayfinding is incorporated via the development of consistent Taksim signage that offers a sense of the new "Taksim brand" as a place that is welcoming to all;

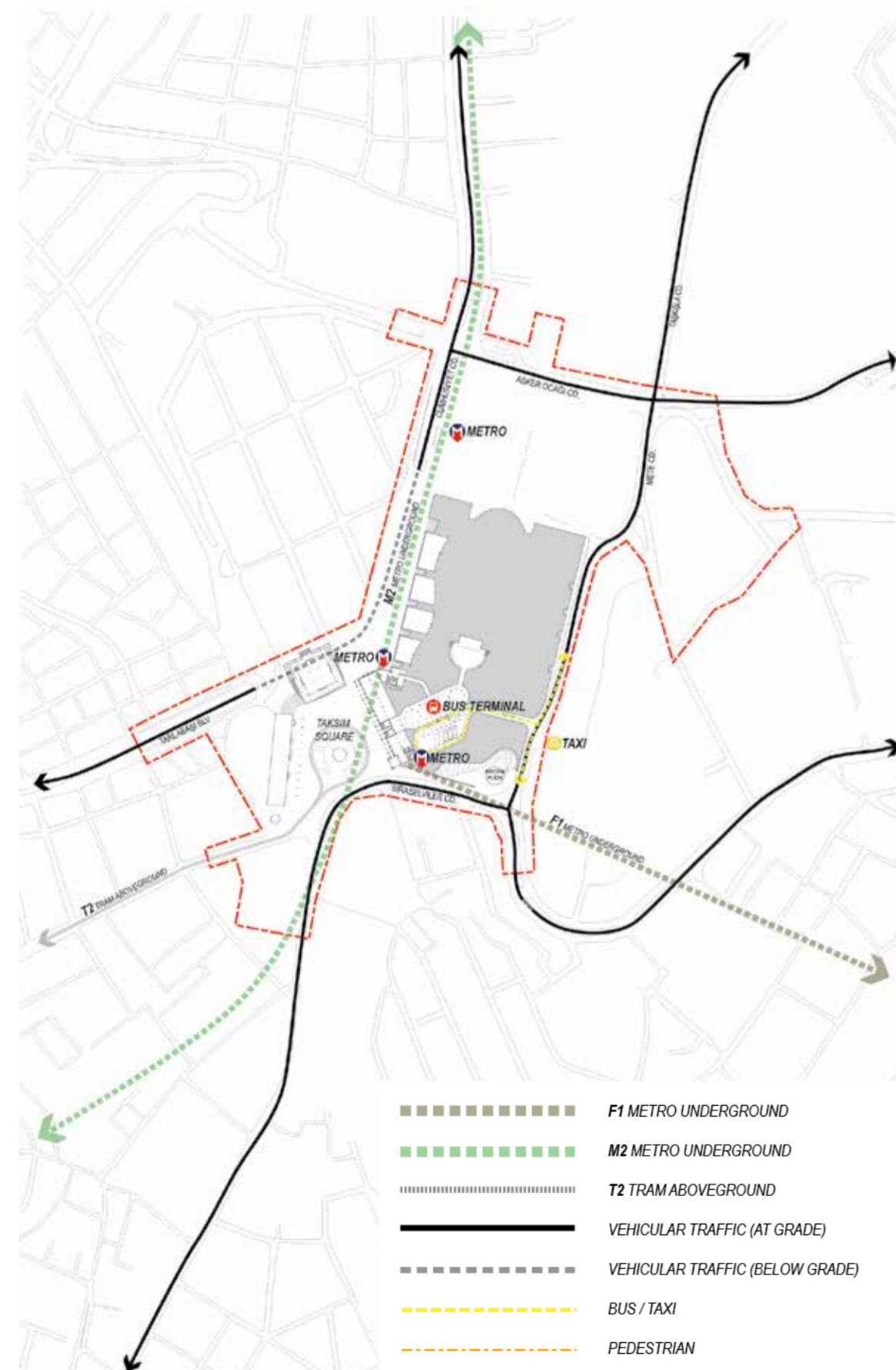

LOCAL TRANSIT DIAGRAM

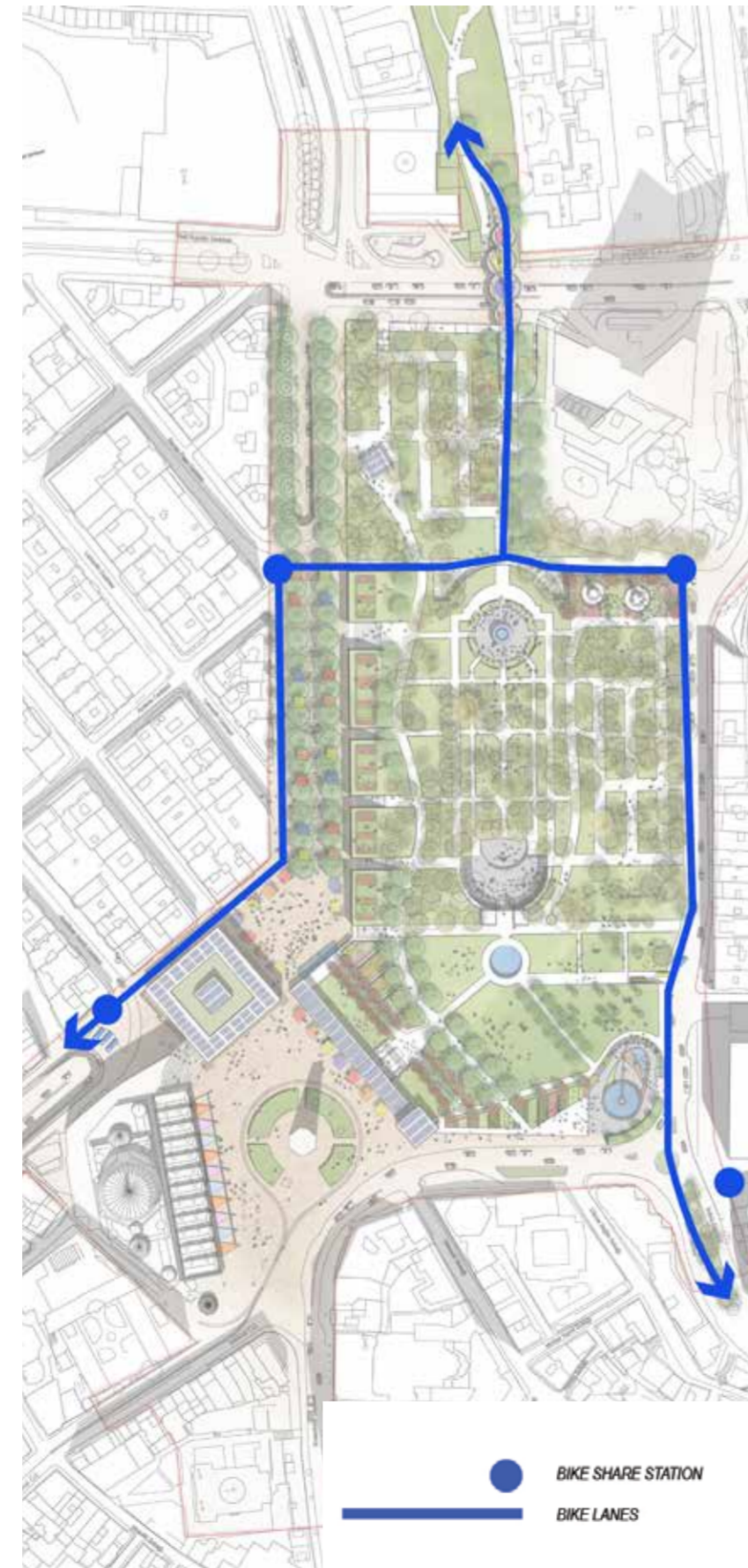

TAKSIM BICYCLE DIAGRAM



6 VIEW FROM TRANSIT OVERLOOK

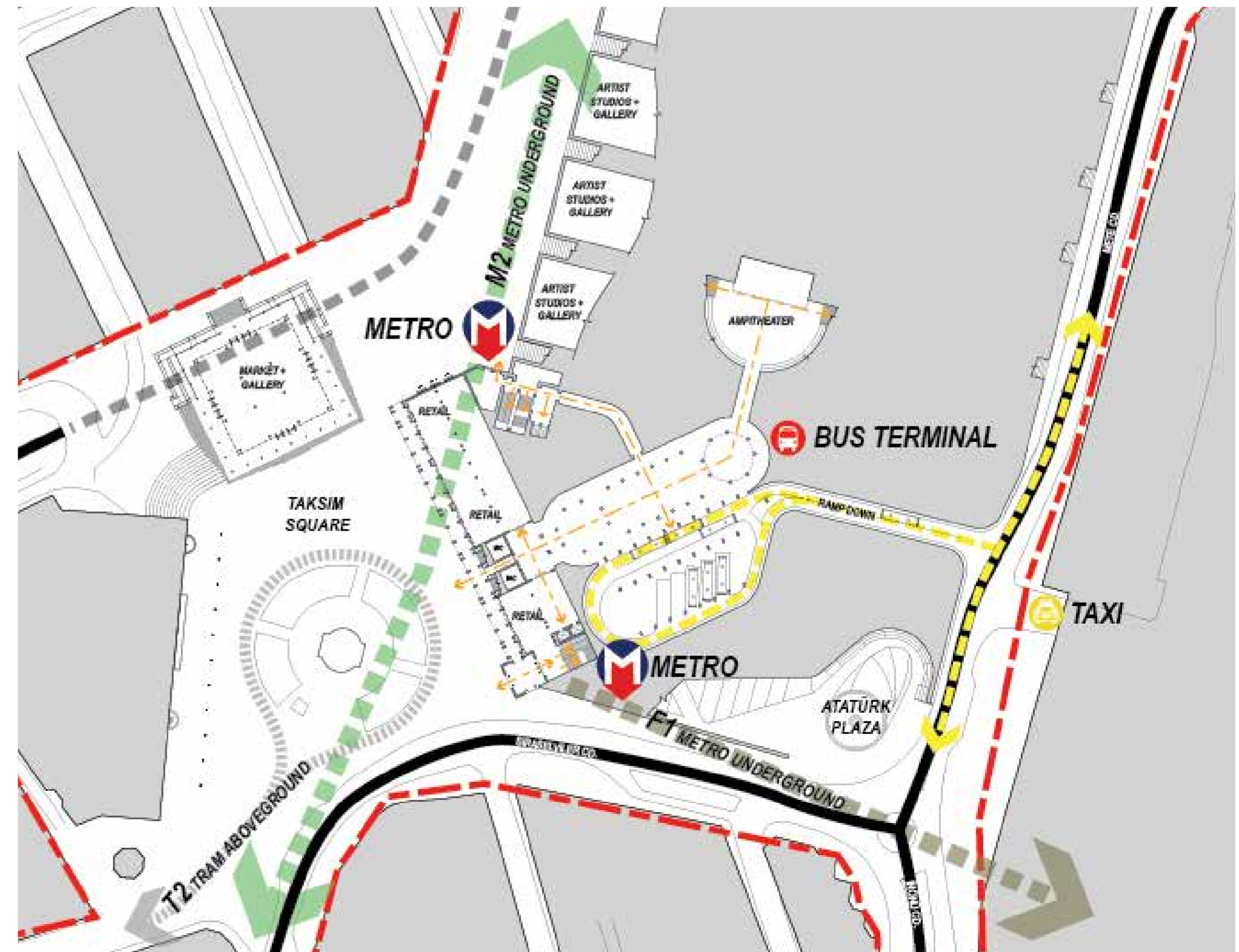

PLAN OF UNDERGROUND BUS TERMINAL

# TAKSIM: THE TRANSPORTATION HUB

# A 21st CENTURY SUSTAINABLE PARK AND SQUARE

## A resilient and sustainable Taksim Square, Park and District

Sustainability represents the integration of environmental, social, and economic value. This holistic framework is integral to our new Taksim Square approach ensuring a positive and quantifiable impact—on people, place, and our planet. Cities around the world must overcome increasingly difficult problems such as rising energy demand, resource utilization, carbon emissions and urban heat island effect, all exacerbated by the changing climate. Our design seeks to foster sustainability and outdoor thermal comfort for Istanbul's prime public realm, integrating sustainability at the core and positioning Istanbul as an exemplary sustainable city in the future of urban design, climate change and resilience. Our sustainable design decisions foster ideal outdoor thermal comfort levels, reduce energy and resource use, and establish a resilient and well-connected community. Drawing inspiration from this unique city which connects continents and cultures, the new Taksim Square and Gezi Park unites sustainability and design excellence in the following strategies:

### SUSTAINABILITY STRATEGIES

- RESILIENCE:** Analyze the environmental conditions and projections of the site to support the proposal with data-backed design decisions by analyzing long term climate change projections, considering seismic requirements and understanding wind and shadow conditions;
- THERMAL COMFORT:** Plan for maximum outdoor thermal comfort to enhance community, walkability, and profitability by employing passive design strategies and integrating climate-responsive shading solutions to provide solar control throughout the year. Design overhangs on south-facing glass to control direct beam solar radiation and the use of deciduous trees to provide shading for summer and allow sun light during winter months;
- ENERGY:** Harvest solar energy where possible to reduce resource utilization and emission levels and maximize daylight while minimizing glare to reduce lighting loads and improve the quality of the indoor and public environments;
- WATER:** Minimize water use with substantial on-site storm-water management and rainwater reuse systems by integrating bio-retention, green roofs and water recycling, and high efficiency irrigation systems;
- HEAT ISLAND EFFECT:** Reduce local heat Island effect by selecting paving and roofing materials with high solar reflectance index (SRI) and integrating vegetated roofs where possible;
- LANDSCAPE:** Integrate native landscaping and planting solutions by using plants which requires no or low irrigation and cater to native pollinator species;
- LIGHTING:** Control light pollution by avoiding light trespass and employing solar powered LED downlight fixtures to reduce energy use, emissions and installation/maintaining cost;
- MATERIALS:** Use local materials, reuse materials where possible, and prioritize materials with high recyclable and low VOC contents;
- WELLNESS:** Provide activity and recreational areas enhanced by public art which can be used by all residents to foster physical and psychological wellness;
- CONNECTION:** Create a strong connection to the natural environment, cultural context, and the urban texture by proposing programs to support social and economic activities, facilitating accessibility, integrating bike paths and providing sustainability education throughout the site area.

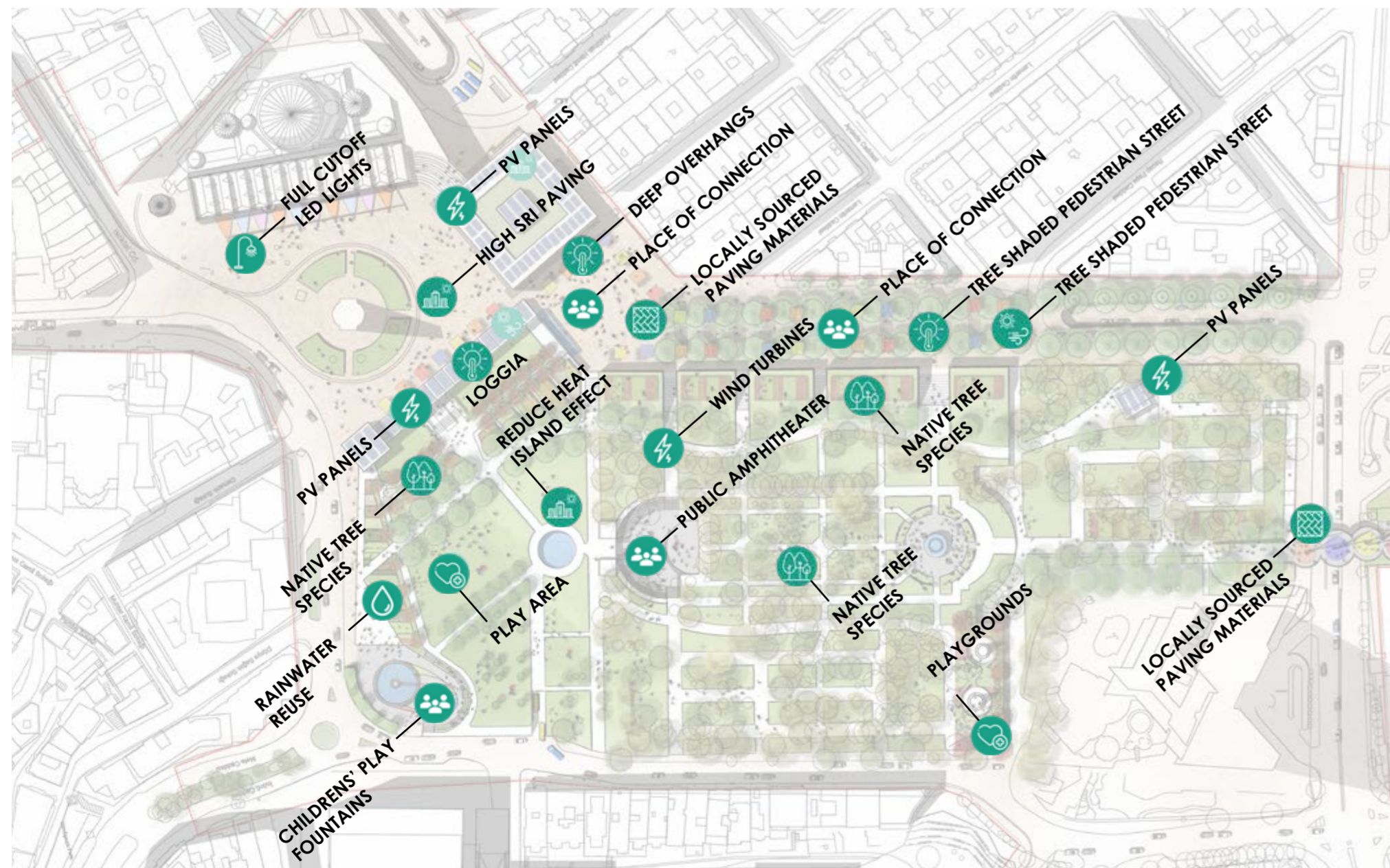

# A 21st CENTURY SUSTAINABLE PARK AND SQUARE

## Site Shadow Studies – Winter Solstice

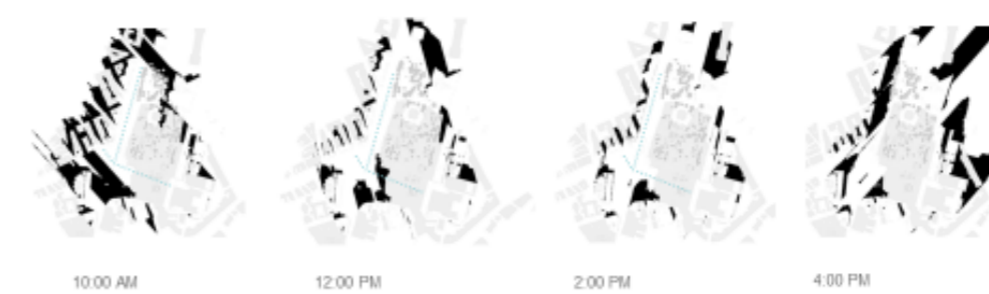

## Site Shadow Studies – Summer Solstice

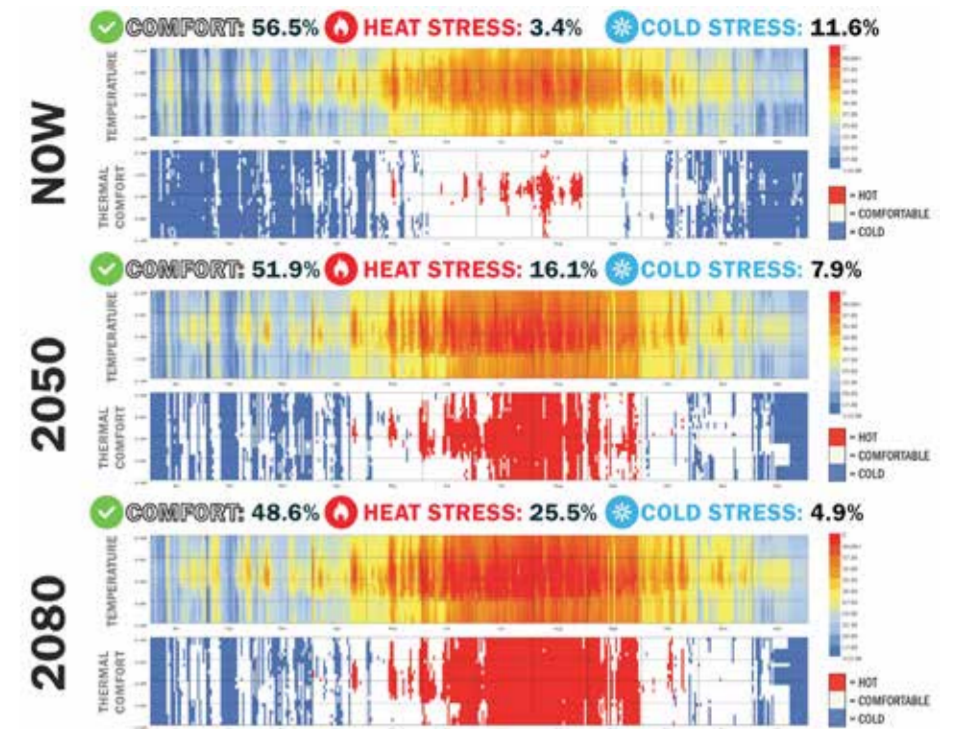
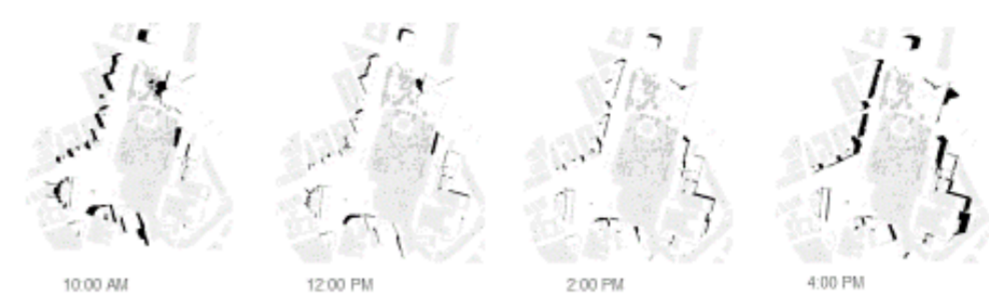

### SHADOW ANALYSIS

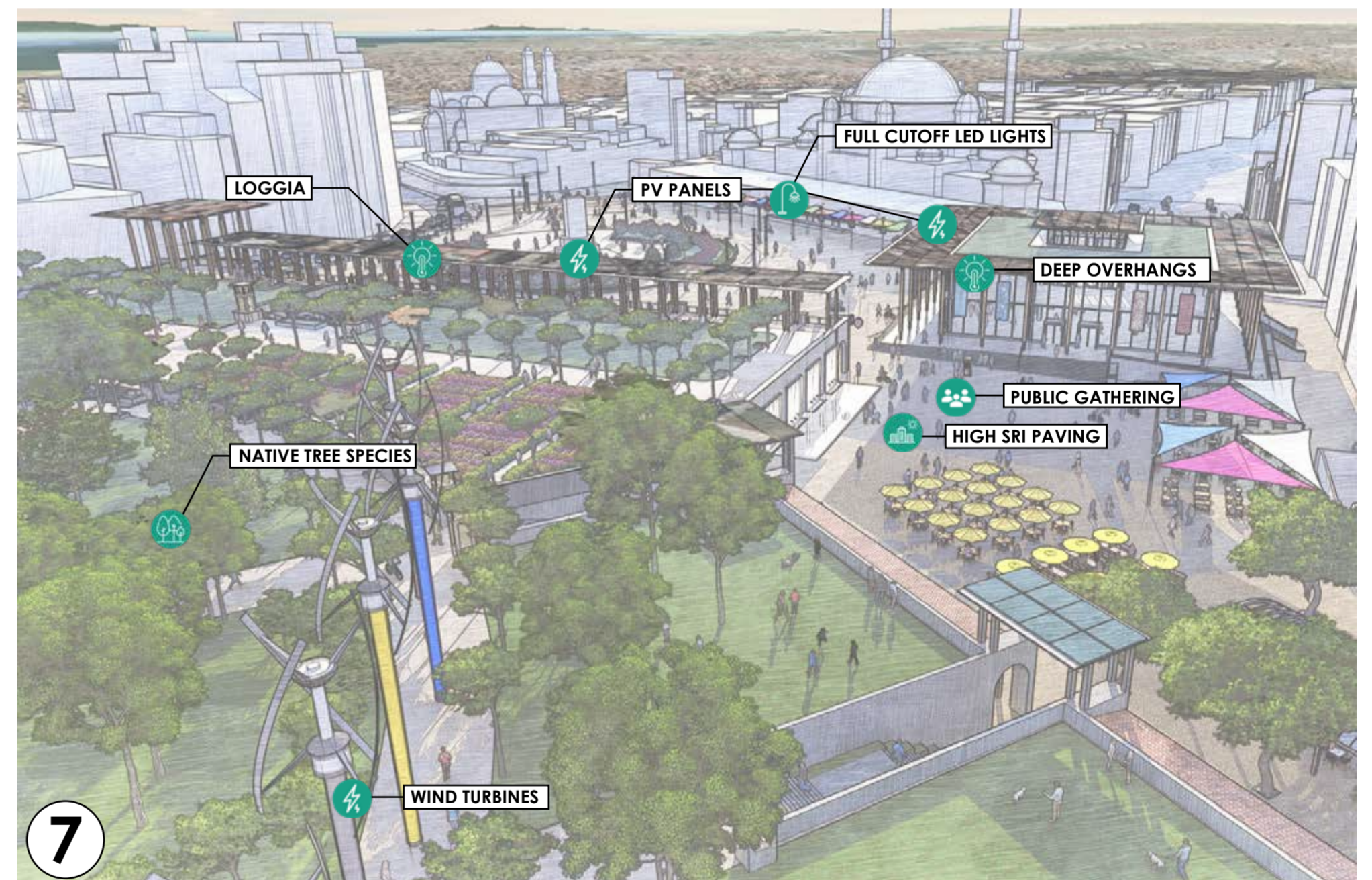

### THERMAL COMFORT ANALYSIS

### Yearly Wind Studies



### Winter Wind Studies



### Summer Wind Studies

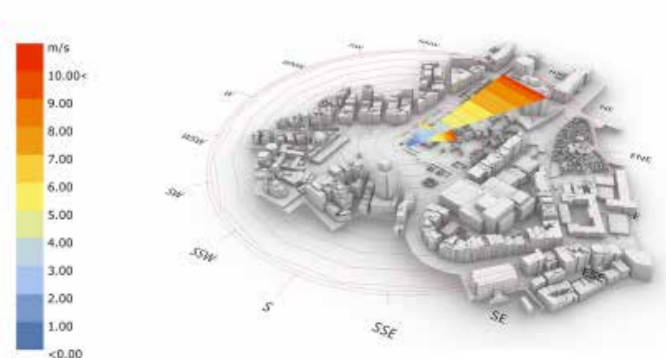

### WIND STUDIES

# A 21st CENTURY SUSTAINABLE PARK AND SQUARE



# TAKSIM'S TRANSFORMATION

